

copy for PC + our Ad Council
Horowitz second Campaign Data

14 Charles Lane
New York, N.Y. 10014

September 6, 1971

BOSTON

Dave Wulp

Dear Dave,

The request of the Boston branch to give critical support to the campaign of Pat Bonner-Lyons for School Committee in Boston will be placed before the Political Committee at its next meeting.

The Administrative Committee has considered the question, and recommends that the Boston branch proceed to intervene in the Bonner-Lyons campaign with the tactic of critical support, given the clear-cut nature of her campaign as a Young Workers Liberation League campaign, the fact that this will not cut across our own campaign for School Committee, and the tactical advantages in moving quickly.

Comradely,

Barry Sheppard
Administrative Committee

Boston
AUG 28 1971

Boston SWP
295 Huntington Ave.
Boston 02115
Aug. 26, 1971

Jack Barnes
SWP NO
14 Charles Lane
New York 10014

Dear Jack,

The Boston branch voted last night to recommend giving critical support to the campaign of Pat Bonner-Lyons for School Committee in Boston. I am sending along a copy of Joe Miles' report to the branch for the executive committee.

There are a couple of things which aren't in Joe's report. First, we are running our own candidate for School Committee also, Mark Friedman (there are nine places being contested). The Friedman campaign was announced during the high school strike last spring and he was able to speak several times during the strike. That campaign has been fairly low-key since then, but we are running a strong mayoralty campaign (Jeff Powers) which has been getting a lot of attention. If we do extend critical support, the CP will be forced to relate to that campaign and explain why they are supporting the Democrat Atkins instead of the socialist Powers. One thing which came out in discussion of Joe's report was that the C.P.P. (Citizens for Participation Politics, antiwar group oriented toward Democratic politicians) has endorsed Bonner-Lyons (and only her) for School Committee.

If the Political Committee agrees that we should extend critical support, could you let us know whether you want an article for the Militant or anything?

When the vote was taken on the motion, there were no opposing votes and four abstentions.

Some samples of the Bonner-Lyons campaign material are enclosed.

If you need any more information, please let us know.

Comradely,
Matilde
Matilde Zimmermann
Acting Organizer

August 24, 1971; Boston Branch

Report by Joe Miles for the Executive Committee to the Branch

There is only one point to the campaign report tonight and that is the recommendation from the exec and from the campaign steering committee that we recommend giving critical support to Pat Bonner-Lyons' campaign for School Committee. (For everyone's information, this motion, if passed, is just a recommendation which goes to the Political Committee for final approval.)

Bonner-Lyons is a member of YWLL, a 23 year old Black hospital worker, running basically on a program of community control of the schools.

I want to give a brief explanation first of just what the tactic of critical support is. First, the tactic of critical support is just that -- a tactic. And, as Cannon said, the emphasis is on the critical, not the support. Critical support means critical with support in quotation marks, not support with critical in quotation marks.

The first question we must clear up is the question of principle. There are certain candidates and parties that we would never support, no matter who they run or what program they put forward. We would never cross class lines to extend any kind of support to a Democratic or Republican party candidate. Giving critical support to Pat Bonner-Lyons does not present us with that problem. The CP and YWLL, counter-revolutionary as they are, are a tendency within the international working class movement, and therefore it is within our principles to support them.

But there are many cases where it would be permissible in terms of principles to use this tactic, and there are very few times we actually choose to use it. The following are the reasons why the exec feels it would be good to use it in this particular case. We must keep in mind, of course, that the tactic of critical support is used solely to build our movement, not the build the campaign of Pat Bonner-Lyons.

First, she is running as an open YWLLer, and they are waging a very serious campaign. They have two functioning campaign offices, and Joel Kuglemas, their most capable organizer, has been assigned to head up the campaign. Twenty YWLLers came from New York City to help with petitioning to get her on the ballot. Mike Zagarell came to speak in support of her campaign. This is the main public activity of the CP here in this period, and they are putting considerable resources into it, which is reflected in the professionalism of the literature, buttons, etc. They have indicated that

they will wage a write in campaign if she loses the September elimination contest, and it is apparent that the write in campaign will be a relatively serious one.

Second, it will enable us to reach the periphery around her campaign. The recent Black Political Convention held in Boston endorsed her campaign. In spite of the fact that the convention was narrowly conceived and was run very tightly by the Congress of African Peoples, there were a certain number of independents and new people drawn in. About 200 people attended the convention during the course of the weekend. I attended a candidates' meeting earlier at which she spoke before about 80 people; there were about 25 YWLLers and other strong campaign supporters there. Eight or 9 of these were Afro-Americans. There are a number of independents who hang around her campaign office, have helped with petitioning, etc.

Third, it may enable us to reach some of the members of YWLL itself. From the experiences of many of our comrades here we know that when you try to get in a political discussion with YWLLers you find that they aren't very political, they weren't recruited on the basis of a political program. One good example of that is the recent article by Doug Jenness about the People's World's attack on the Australian CP for mentioning Andrew Pulley. Their nervousness reflects a sympathy within the ranks of the CP and YWLL for Trotskyist ideas.

Four, it makes it possible to approach her and the campaign to do such things as have joint forums, debates, etc. They have refused to debate us so far but this would put a great deal more pressure on them to enter into political discussion with us.

Fifth, and a more minor point, is that it would clear up any confusion which might possibly exist among our campaign supporters. Because her public program is so similar to ours, some of our supporters might be confused and think us slightly sectarian for not supporting her. At the same time, we must be clear among ourselves that we are not supporting her program or supporting her primarily because of her program.

Lastly, and most important, giving her critical support will enable us to build our campaign in Boston and Cambridge. It will put pressure on them to support our campaigns, and gives us another arena and area of work in which to talk to people, win them to our ideas, and recruit them.

WE NEED

*A coalition of students, teachers and parents - for good schools now!
We urge ALL who are willing to fight now for the needs of the people of
Boston to join with us.*

BUT

*Racism is the main tool used by the School Committee to divide
out students from students, teachers from students, parents from
teachers. Meanwhile, the schools deteriorate, our powerlessness grows. We
cannot be used any more: only unity can win.*

JOIN US!

*This is what it is going to take - this is what our campaign is all about.
Black, Brown and white - unite and fight to win!*

--- Please send me more information about Pat's campaign.

--- I am interested in working on the campaign:

high school committee ---

neighborhood committee ---

teacher's committee ---

--- I want to donate \$ _____ to the campaign.

Name _____

Address _____
street city zip

Phone _____ Occupation _____ Age _____

Committee to Elect Bonner-Lyons to the School Committee
270 Norfolk Street, Dorchester, Massachusetts 02124
Telephone (617) 287 - 9480 or 288 - 2997

PAT BONNER-LYONS

CANDIDATE FOR

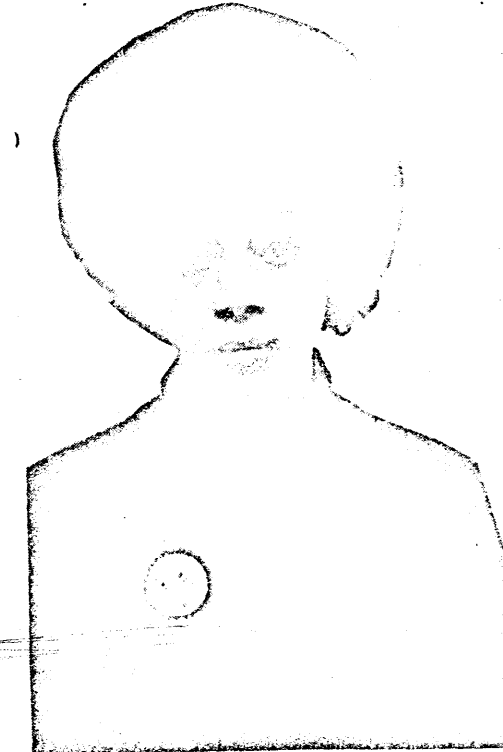

WHO WE ARE

Pat Bonner-Lyons, a 23 year old Black mother, is a graduate of Lincoln University. She is a hospital worker and active unionist, and has been involved in civil rights and the peace movement. She is a member of the Young Workers Liberation League which is sponsoring her campaign.

Pat's organization, the YWLL, is a Black and white socialist youth organization whose national membership has passed 1500 during its first year. The Boston League includes high school students and teachers, unemployed youth, young parents and workers.

The YWLL is active in freeing Angela Davis and all political prisoners, organizing unorganized workers into unions, building a rank and file workers' movement, fighting unemployment, and uniting all young people against war, racism and repression -- now!!!

SCHOOL COMMITTEE

Let's build a people's movement --

to end racism in the school system

*to get representation for the people -- not
the politicians*

*to get the money we need from the rich,
not the poor*

*to get a meaningful education --
not mis-education*

Committee to Elect Bonner-Lyons to the School Committee
270 Norfolk Street, Dorchester, Massachusetts 02124
Telephone (617) 287 - 9480 or 288 - 2997

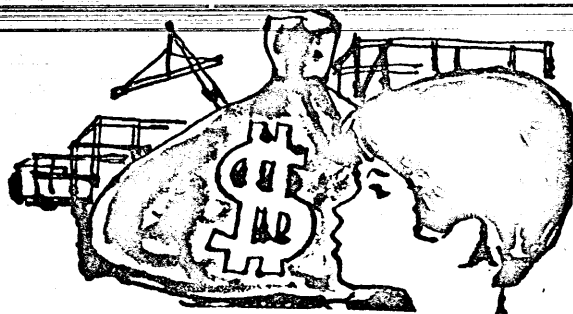

WE NEED QUALITY EDUCATION

PAT BONNER-LYONS STANDS FOR

- An end to the tracking system that prepares a few for college and the rest for \$1.60/hour dead-end jobs.
- Courses that teach honestly about the history of Black people and labor.
- Vocational training for jobs with a future.
- Paid job training for drop-outs.
- Black studies in every school and for every student.
- Bi-lingual (Spanish and English) classes and texts and teachers and counselors.
- Full freedom and generous funds for teachers and students to adopt creative new methods.

We want education that teaches youth to think, not just memorize. Students must be prepared for jobs that provide decent income, dignity and security. Every student has the right to a complete education, including college, regardless of parental income.

WE NEED OUR MONEY'S WORTH

PAT BONNER-LYONS STANDS FOR

- New schools in every part of Boston.
- Schools with whole windows, readable blackboards and functional heating plants, modern equipment and up to date books.
- More teachers, counselors, librarians and aides.
- Continuous teacher education.
- Health care for students.
- Full-day kindergartens, and evening community use of our schools.
- Stipends for students who cannot afford to continue full-time schooling.
- Immediate withdrawal from Indochina.

Boston property taxes have increased over 100% in the past few years and what have we gotten besides overcrowded classrooms and patch-work repairs on ancient buildings? We need new priorities now -- not new taxes. The banks, the big realtors, the big land holders don't need relief. Get the people's money back to the people -- tax the rich and not the poor. Get blood money out of the rich man's war and into the schools -- now!

WE NEED A FREE AND DEMOCRATIC EXCHANGE OF IDEAS, AND FULL EQUALITY OF OPPORTUNITY'

PAT BONNER-LYONS STANDS FOR

- An end to de facto segregation by any means necessary.
- An end to tests which discriminate because of culture or language.
- More Black and Spanish-speaking teachers and counselors.
- No rigid, biased hiring practices.
- The right to strike of teachers and students.
- No suspensions, expulsions, harassment and firings of students and teachers who fight for change.
- Police out of the schools; repression must stop.
- Recognition of the high-school Bill of Rights.
- An end to military recruitment in the schools.
- Drugs out of the schools; drug education, help for the addicted, jail for the syndicate.

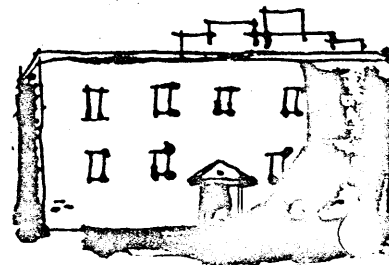

WE NEED A SCHOOL COMMITTEE THAT REPRESENTS ALL THE PEOPLE OF BOSTON

PAT BONNER-LYONS STANDS FOR

- An elected School Committee with high school students as voting members.
- Guaranteed Black and Puerto Rican representation.
- Constant consultation with teachers and their union on all matters.
- An independent, democratic Home and School Association.
- Fully funded Parent's and Teachers' Councils.
- Who is not represented on the School Committee? Students, youth, the Black, Puerto Rican communities, the white working class -- in other words, the people of Boston are not represented! We demand a School Committee that represents the people of Boston. Only a coalition of Black, Brown and white parents, teachers, and the community can fight effectively for this power.